

S

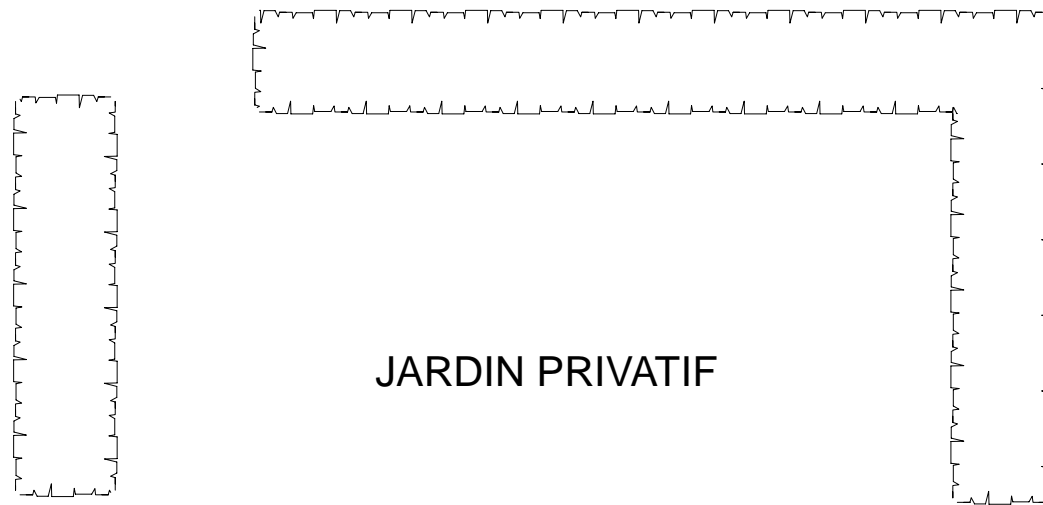

JARDIN PRIVATIF

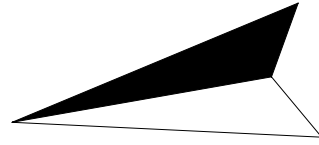
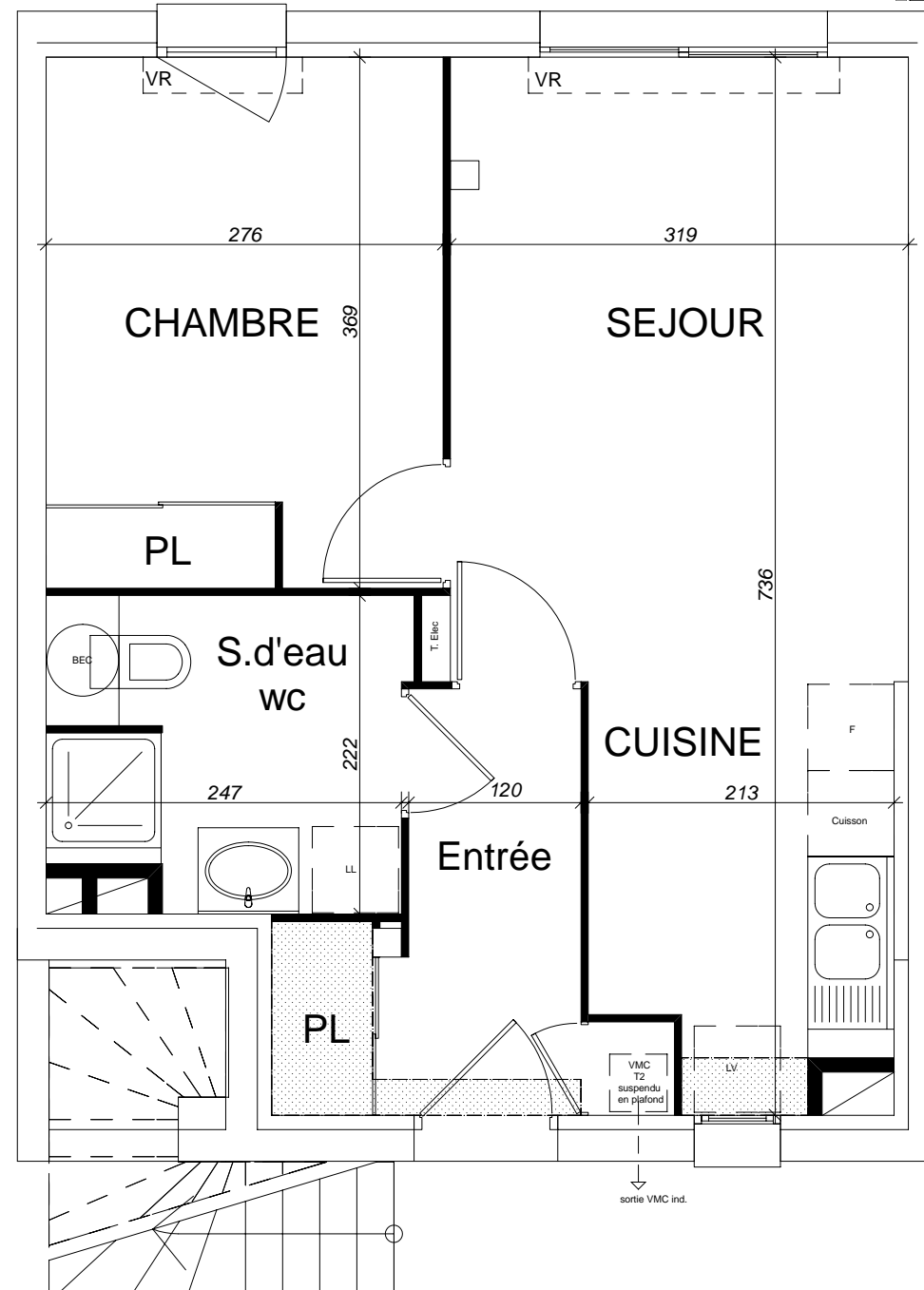

APPARTEMENT N°A 102	ETAGE RDC
TYPE T2	
Surfaces habitables	
Entrée+ Pl.	5.20 m ²
Séjour + Cuisine	19.54 m ²
WC + Salle d'eau	5.21 m ²
Chambre+Pl.	10.18 m ²
TOTAL	40.13 m²
Jardin	20.65 m ²

